

BANTAM SNIPER parts list for bolt action gun.

NOTE: Some of these part numbers/names may be incorrect.

USE AS A REFERENCE GUIDE ONLY.

1	action block
2	washer front of bolt probe
3	BK27 – Pack of 5
4	rear plug seal
5	brass rear screw
6	pellet probe
7	cocking bolt lever
8	main cocking bolt tube
9	rear bolt allen bolt
10	hammer pin/ cocking dog
11	cocking bolt retainer ball bearing x2 (N.ES x2)
12	cocking bolt handle spring
13	cocking bolt handle
14	bolt handle screw
15	bolt location tension spring
16	bolt location grub screw
17	barrel
18	4.5mm/.177: BK33 – Pack of 5
18	5.5mm/.22: BK49 – Pack of 5
18	6.35mm/.25: BK58.5 – Pack of 5
19	4.5mm/.177 & 5.5mm/.22: BK75.3 – Pack of 5
19	6.35mm/.25: BK87.6 – Pack of 5
20	barrel retaining grub screws (2)
21	main valve seal
22	BK76 – Pack of 5
23	valve rod
24	valve rod spring

25	hammer body
26	SS (SS= sling shot hammer) inside hammer weight
27	SS Hammer washer
28	SS Rear hammer pin
29	SS Front hammer spring
30	SS Front hammer small pin
31	SS Front side hammer pin
32	SS Middle side hammer pin
33	SS Hammer spring
34	hammer anti bounce/noise silencer spring buffer (both hammer types)
35	SH (SH= solid hammer)hammer
36	SH rear hammer pin
37	SH front hammer small pin
38	SH Hammer spring
39	power adjuster switch
40	BK49 – Pack of 5
41	power adjuster pin
42	power adjuster retainer spring
43	washer
44	valve front
45	BK105.8 – Pack of 5
46	trigger lever to hammer sear
47	trigger sear spring
48	trigger sear brass retainer
49	5x breech O ring seals
50	front trigger adjustment screw
51	trigger location pin
52	front trigger sear adjustment screw
53	rear trigger spring
54	rear trigger sear adjustment screw

55	safety lever ball bearing x2(D.ssx2)
56	safety lever spring
57	left rear lower action screw
58	right rear lower action screw
59	trigger base hold down bolts (4)
60	main pressure gauge
61	BKD8 – Pack of 3
62	trigger sear brass retainer
63	main regulated valve body to action attachment screws (2)
64	trigger sear
65	trigger blade
66	safety lever
67	safety level long pins (2)
68	safety spring or grub screws (2)
69	
70	trigger base
71	shroud to action adaptor
72	action pins grub screw
73	BK123 – Pack of 5
74	barrel shroud
75	end cap adaptor
76	barrel thread protector end cap
77	barrel centering collar
78	front barrel center locator O ring
79	
80	butt pad
81	rear butt pad attachment screw nut
82	rear butt pad attachment screw
83	butt pad screws (2)
84	front scope 11 mm rail
85	front scope 11 mm rail screws (2)

86	lower front rail nuts
87	regulator outside body
88	inlet fill valve male connector
89	inlet fill valve piston
90	washer ?
91	inlet fill valve screw & filter
92	inlet fill valve spring
93	BK11 – Pack of 5
94	filling Port Cover
95	filling Port Cover magnets
96	BK107.6 – Pack of 5
97	bottle
98	regulated main valve body
99	huma regulator gauge
100	stock attachment bolt
101	regulator
102	trigger long adjusting screw
103	stock
104	rear front top stock plate bolts (4)
105	fill port body
106	non regulated parts
107	non regulated parts
108	non regulated parts
109	non regulated parts
110	non regulated parts
111	cheek rest
112	cheek rest collar (2)
113	cheek rest adjuster screws (2)
114	cheek rest collar screws (4)

Diagram on next page.

BANTAM

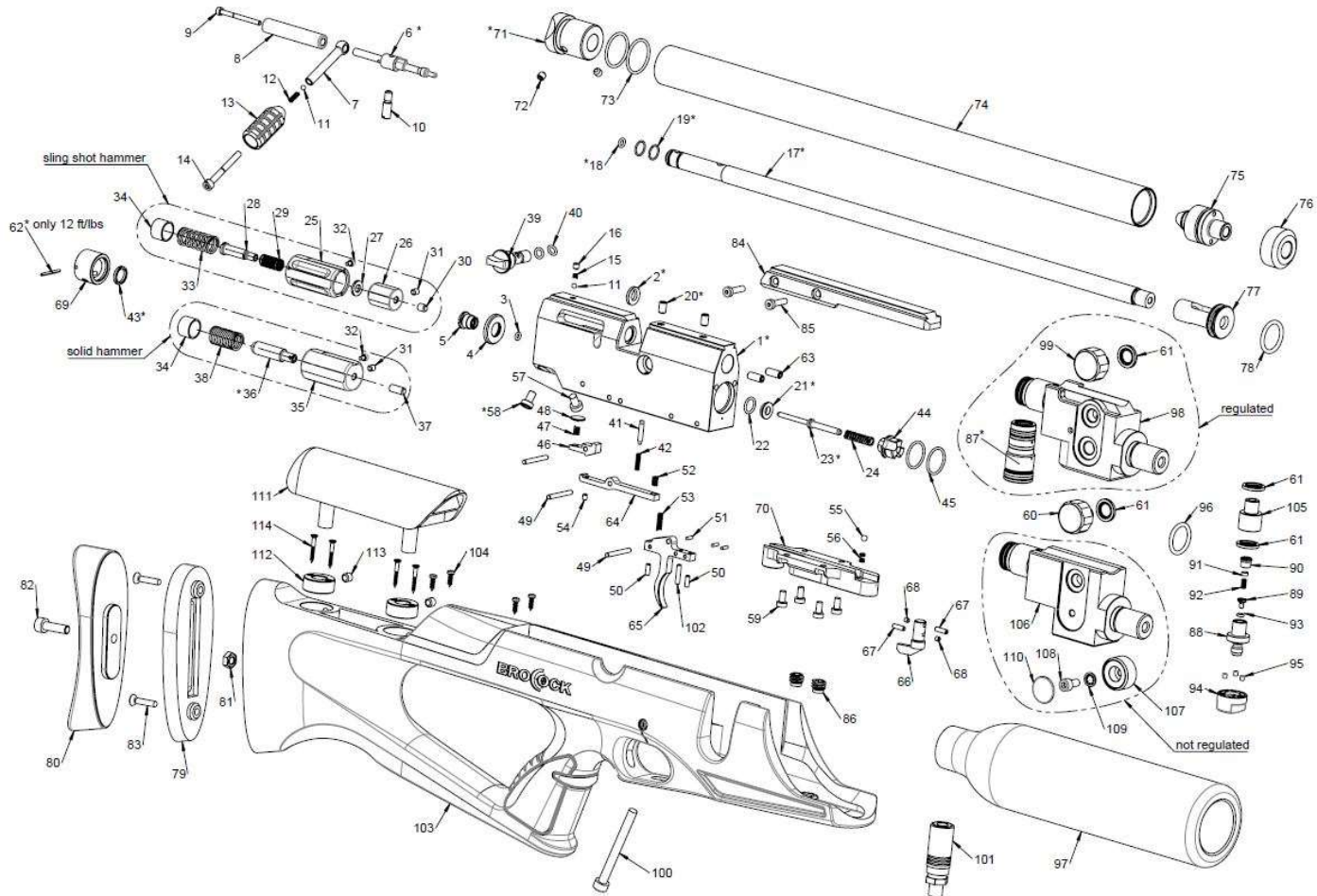

* VARIABLE PARTS