

Assembly Instructions For HP-P1000W/HP-P900W

Date: July 2018

P1WA	(A) Air reservoir front part assembly	pg.02
P1WB	(B) Air reservoir overall assembly	pg.03
P1WC	(C) Pellet probe assembly	pg.04
P1WD	(D) Hammer and spring assembly	pg.05
P1WE	(E) Power adjustment valve assembly	pg.06
P1WF	(F) Side lever action handle assembly	pg.07
P1WG	(G) Safety assembly	pg.08
P1WH	(H) Trigger and air release valve assembly	pg.09
P1WI	(I) Pressure relief valve front part assembly	pg.10
P1WJ	(J) Pressure relief valve rear part assembly	pg.11
P1WK	(K) Inner barrel assembly	pg.12
P1WL	(L) Shroud barrel and regulator chamber assembly	pg.13
P1WM	(M) Leakage and regulator test	pg.14
P1WN	(N) Stock assembly	pg.15
P1WO	(O) Spare parts and packaging	pg.16

(A) Air reservoir front part assembly

Process Code: P1WA

Date: July 2018

Video Code: V-P1WA

Version: 1.0

Product Code: HP-P1000W/HP-P900W

Product Name: P1W (Wood) .177/.22

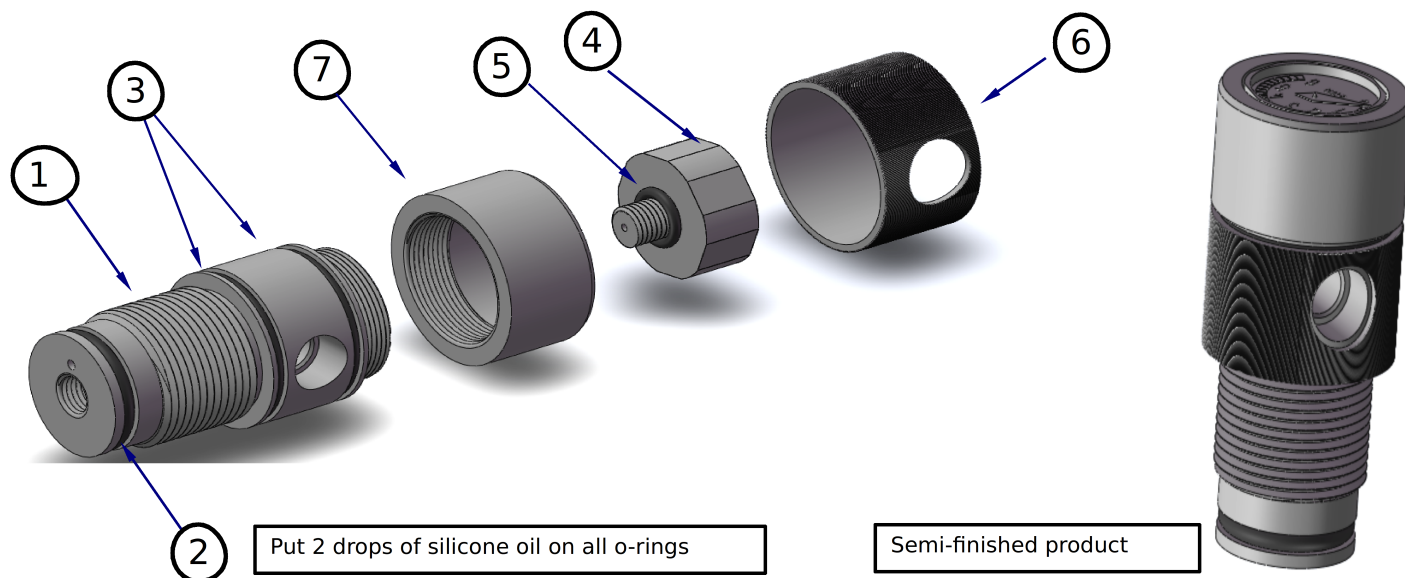

No	Material Name	Material Code	Quantity	Remark
1	Air reservoir front plug	000P1-007-W-00	1	
2	NBR o-ring $\phi 3 \times \phi 24$ hardness 90°	000P1-006-X-00	1	
3	NBR o-ring $\phi 2 \times \phi 31$ hardness 90°	000P1-027-X-00	2	
4	Pressure gauge P1	000P1-002-W-00	1	
5	NBR o-ring $\phi 2 \times \phi 12$ hardness 90°	000P2-007-X-00	1	
6	Air reservoir front plug ring	000P1-017-W-00	1	
7	Pressure gauge protective cap	000P1-055-W-00	1	
8				
9				
10				
11				
12				
13				
14				
15				

(B) Air reservoir overall assembly

Process Code: P1WB

Date: July 2018

Video Code: V-P1WB

Version: 1.0

Product Code: HP-P1000W/HP-P900W

Product Name: P1W (Wood) .177/.22

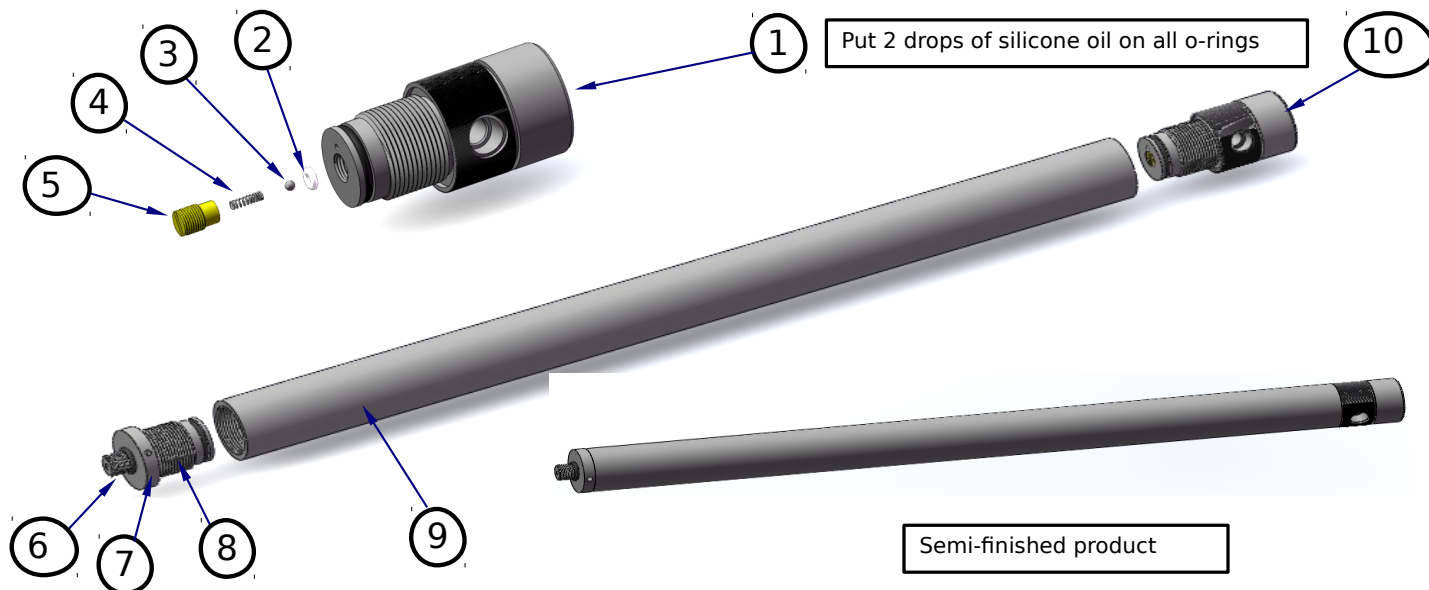

No	Material Name	Material Code	Quantity	Remark
1	Air reservoir front plug Semi-finished product	/	1	
2	PU o-ring $\phi 2.2 \times \phi 7$ hardness 90° (milk white colour)	000P1-025-X-00	1	
3	Steel ball $\phi 3$	000P2-026-W-00	1	
4	Air reservoir front plug check valve spring	000P1-020-W-00	1	
5	Air reservoir front plug check valve screw	000P1-019-W-00	1	
6	Air reservoir rear plug	000P1-0007-W-00	1	
7	NBR o-ring $\phi 2.5 \times \phi 15$ hardness 90°	000P1-026-X-00	1	
8	NBR o-ring $\phi 3 \times \phi 24$ hardness 70°_x000D_	000P1-006-X-00	1	
9	Air reservoir tube	000P1-006-W-00	1	
10	Air reservoir front plug Semi-finished product	/	1	
11				
12				
13				
14				
15				

(C) Pellet probe assembly

Process Code: P1WC

Date: July 2018

Video Code: V-P1WC

Version: 1.0

Product Code: HP-P1000W/HP-P900W

Product Name: P1W (Wood) .177/.22

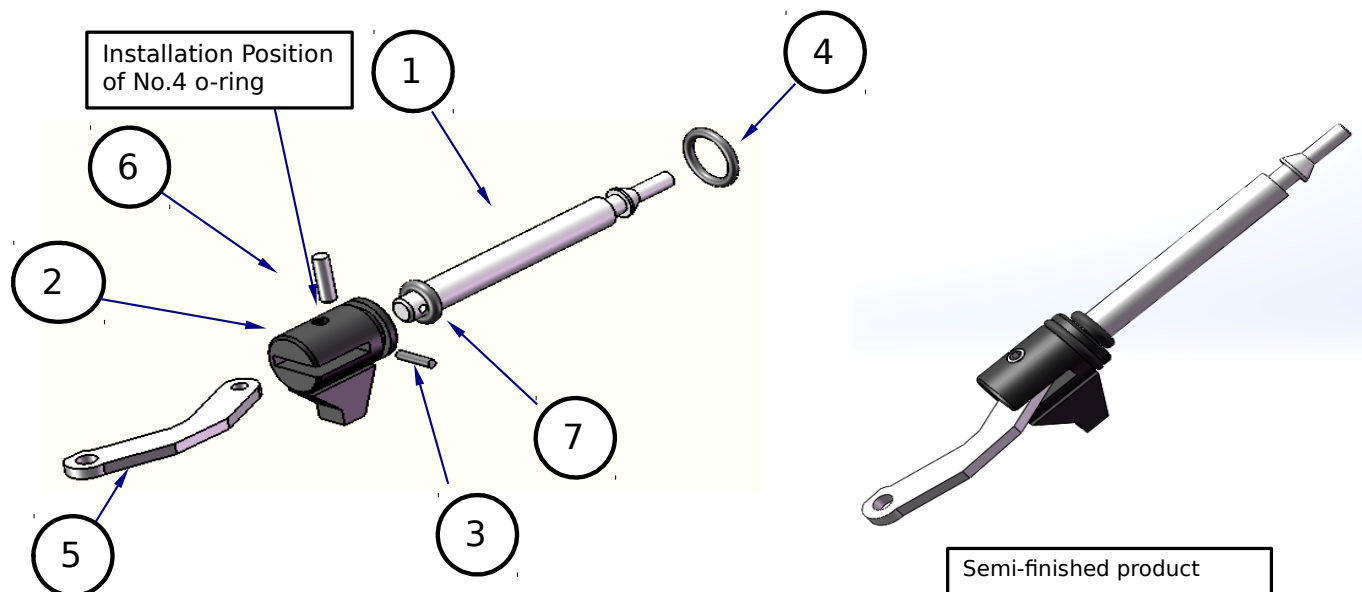

No	Material Name	Material Code	Quantity	Remark
1	Pellet probe	000P1-058-W-00 (.177) / 000P1-028-W-00 (.22)	1	
2	Pellet probe seat	000P2-182-W-00	1	
3	Pellet probe pin $\phi 1.5 \times 7$ (45-h8)	000P2-064-W-00	1	
4	Pellet probe seat o-ring NBR $\phi 1.5 \times \phi 11$ hardness 90°	000P2-036-X-00	1	
5	Side lever action connecting rod	000P2-061-W-00	1	
6	Side lever action connecting rod front pin	000P2-183-W-00	1	
7	Pellet probe rear o-ring NBR $\phi 2 \times \phi 8$ hardness 90°	000P2-037-X-00	1	
8				
9				
10				
11				
12				
13				
14				
15				

(D) Hammer and spring assembly

Process Code: P1WD

Date: July 2018

Video Code: V-P1WD

Version: 1.0

Product Code: HP-P1000W/HP-P900W

Product Name: P1W (Wood) .177/.22

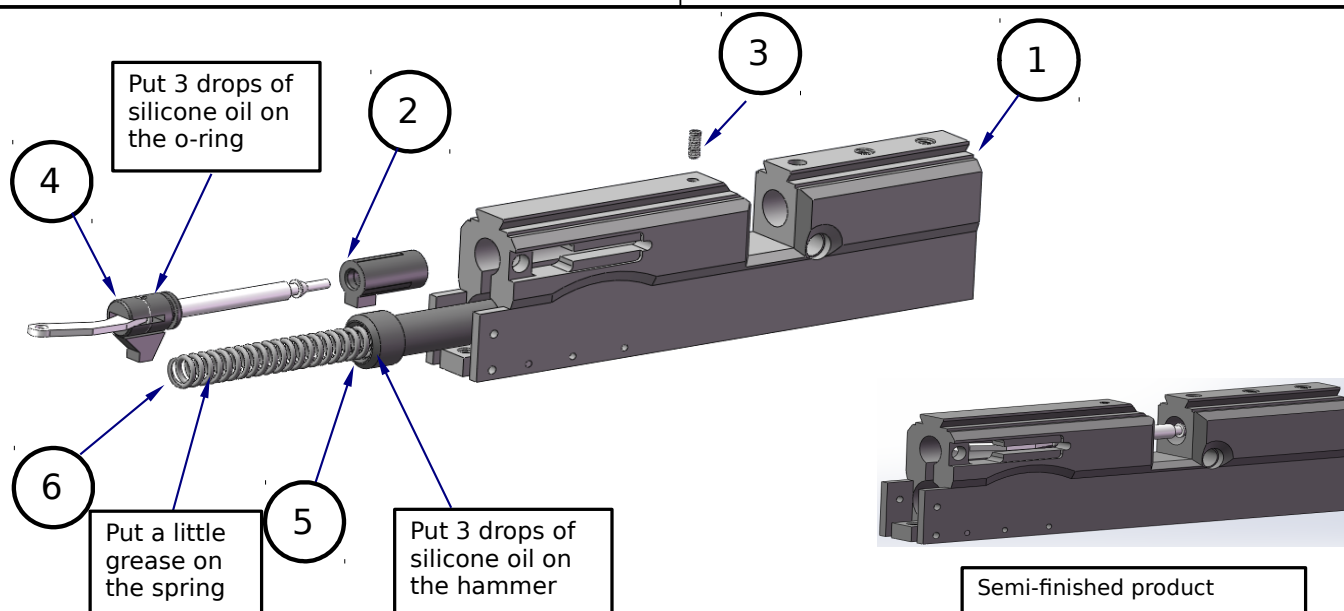

No	Material Name	Material Code	Quantity	Remark
1	Aluminum valve body	/	1	
2	Pellet probe cap	000P1-025-S-00 (.177) / 000P1-008-S-00 (.22)	1	
3	Cone point allen screw M3×8	000P2-185-W-00	1	
4	Pellet probe Semi-finished product	/	1	
5	Hammer P1 (P1/P2)	000P1-059-W-00	1	
6	Hammer spring P1	000P2-079-W-00	1	
7				
8				
9				
10				
11				
12				
13				
14				
15				

(E) Power adjustment valve assembly

Process Code: P1WE

Date: July 2018

Video Code: V-P1WE

Version: 1.0

Product Code: HP-P1000W/HP-P900W

Product Name: P1W (Wood) .177/.22

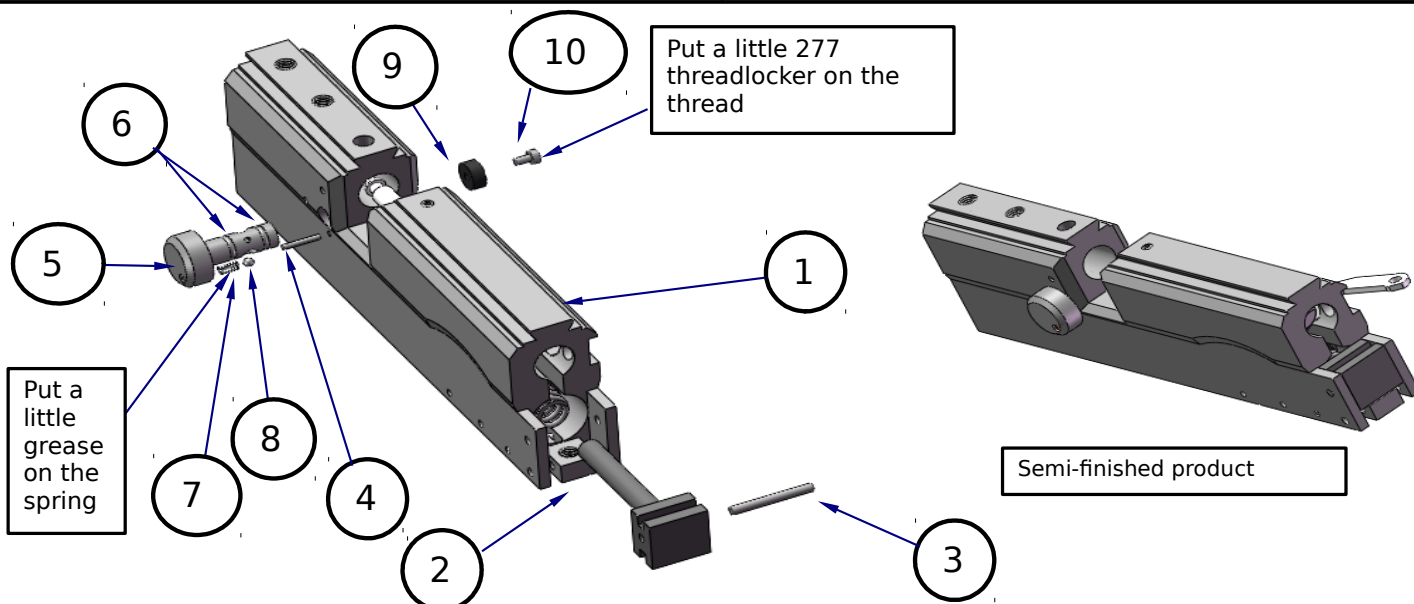

No	Material Name	Material Code	Quantity	Remark
1	Side lever action Semi-finished product aluminum valve body	/	1	
2	Cocking bracket 2	000P2-007-S-00	1	
3	Aluminum valve body horizontal pin 2	000P1-085-W-00	1	
4	Steel pin	000P1-027-W-00	1	
5	Power adjustment valve	000P2-043-W-00 (.177) / 000P2-026-W-00 (.22)	1	
6	Power adjustment valve o-ring NBR $\phi 1.5 \times \phi 7$	000P2-031-X-00	2	
7	Power adjustment valve spring $\phi 0.32 \times \phi 2.32 \times 6.34$	000P2-045-W-00	1	
8	Bearing steel ball $\phi 2.5$	000P1-044-W-00	1	
9	Power adjustment valve washer	000P2-005-S-00	1	
10	Round head allen screw M2 \times 4	000P1-042-W-00	1	
11				
12				
13				
14				
15				

(F) Side lever action handle assembly

Process Code: P1WF

Date: July 2018

Video Code: V-P1WF

Version: 1.0

Product Code: HP-P1000W/HP-P900W

Product Name: P1W (Wood) .177/.22

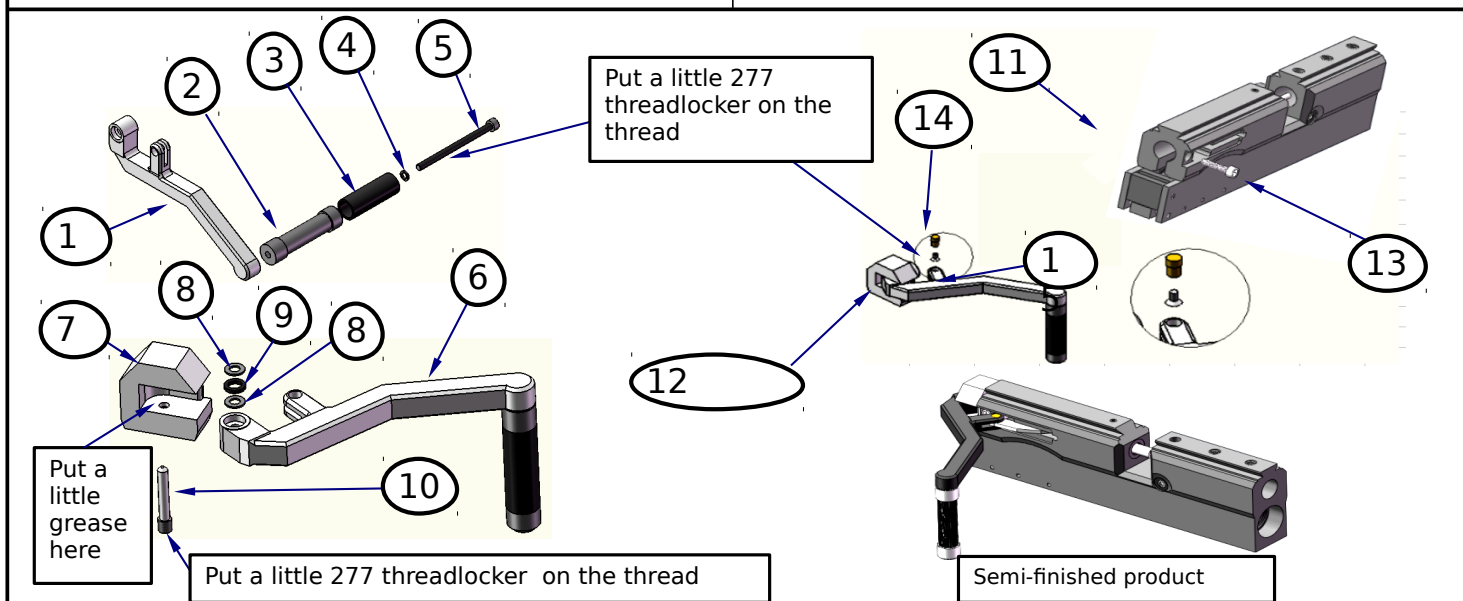

No	Material Name	Material Code	Quantity	Remark
1	Side lever action pull rod (vertical)	000P2-063-W-00	1	
2	Side lever action handle	000P2-133-W-00	1	
3	Side lever action handle sleeve	000P2-040-X-00	1	
4	Standard spring washer $\phi 3.1 \times 4.7 \times 0.8$	000P2-135-W-00	1	
5	Round head allen screw M3 \times 45	000P2-134-W-00	1	
6	Side lever action pull rod Semi-finished product	/	1	
7	Cocking bracket 1	000P2-082-W-00	1	
8	Small flat washer $\phi 3.2 \times \phi 6 \times 0.5$	000P2-066-W-00	1	
9	Standard spring washer $\phi 4.1 \times \phi 6.3 \times 1.1$	000P2-067-W-00	2	
10	Cocking bracket 1 vertical pin	000P2-084-W-00	1	
11	Aluminum valve body semi-finished product	/	1	
12	Side lever action pull rod Semi-finished product	/	1	
13	Round head allen screw M3 \times 15	000P2-083-W-00	1	
14	Side lever action pull rod rear screw	000P2-062-W-00	1	
15	Flat head philips screw	000P2-058-W-00	1	

(G) Safety assembly

Process Code: P1WG

Date: July 2018

Video Code: V-P1WG

Version: 1.0

Product Code: HP-P1000W/HP-P900W

Product Name: P1W (Wood) .177/.22

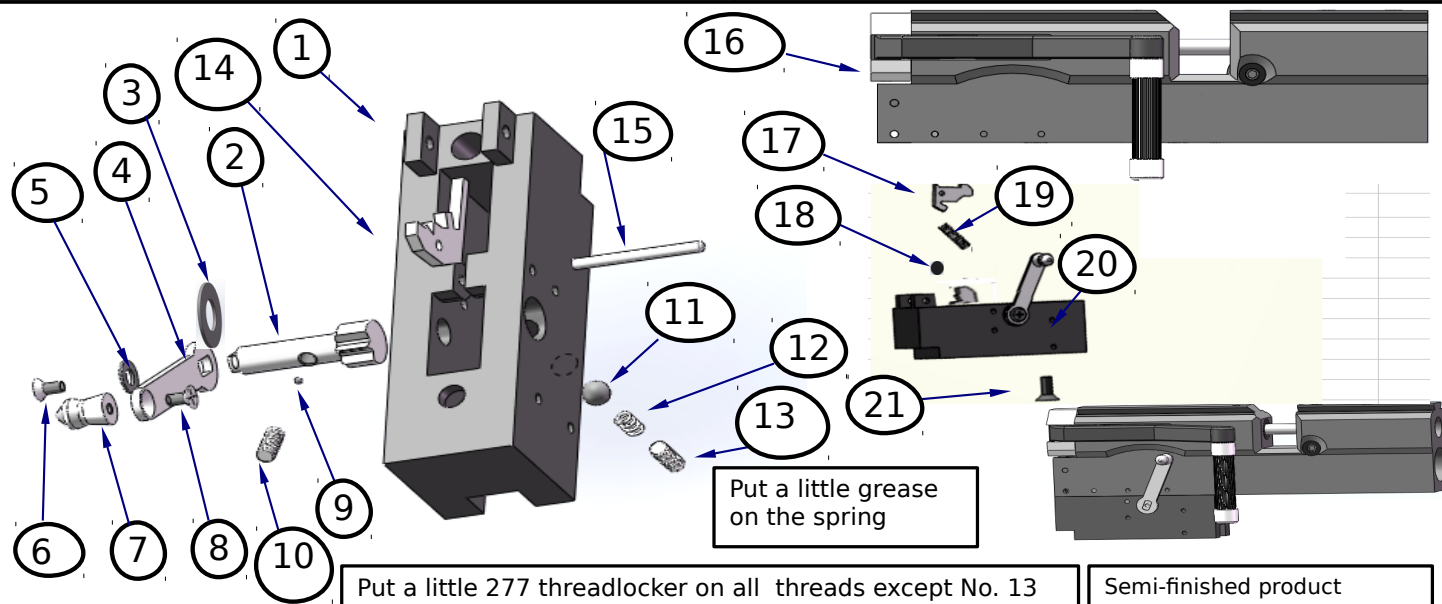

No	Material Name	Material Code	Quantity	Remark
1	Cocking bracket 3	000P2-008-S-00	1	
2	Safety stem	000P2-073-W-00	1	
3	Safety washer	000P2-160-W-00	1	
4	Safety rod	000P2-069-W-00	1	
5	Flat washer $\phi 3 \times \phi 6.5 \times 0.5$	000P2-066-W-00	1	
6	Flat head philips screw type-Z M2X5	000P2-096-W-00	1	
7	Safety knob	000P2-068-W-00	1	
8	Flat head philips screw type-H M2x5	000P2-070-W-00	1	
9	Steel ball $\phi 1.2$	000P2-162-W-00	1	
10	Flat point allen screw M3X10	000P2-089-W-00	1	
11	Bearing steel ball	000P2-163-W-00	1	
12	Safety spring	000P2-071-W-00	1	
13	Flat point allen screw M5x5	000P2-155-W-00	1	
14	Trigger iron	000P2-080-W-00	1	
15	Aluminum valve body horizontal pin 1	000P2-091-W-00	1	
16	Aluminum valve body semi-finished product	/	1	
17	Sear	000P2-081-W-00	1	
18	Aluminum valve body horizontal pin 1	000P2-091-W-00	1	
19	Sear spring	000P2-159-W-00	1	
20	Safety semi-finished product	/	1	
21	Flat head allen screw M4x8	000P2-076-W-00	1	

(H) Trigger and air release valve assembly

Process Code: P1WH

Date: July 2018

Video Code: V-P1WH

Version: 1.0

Product Code: HP-P1000W/HP-P900W

Product Name: P1W (Wood) .177/.22

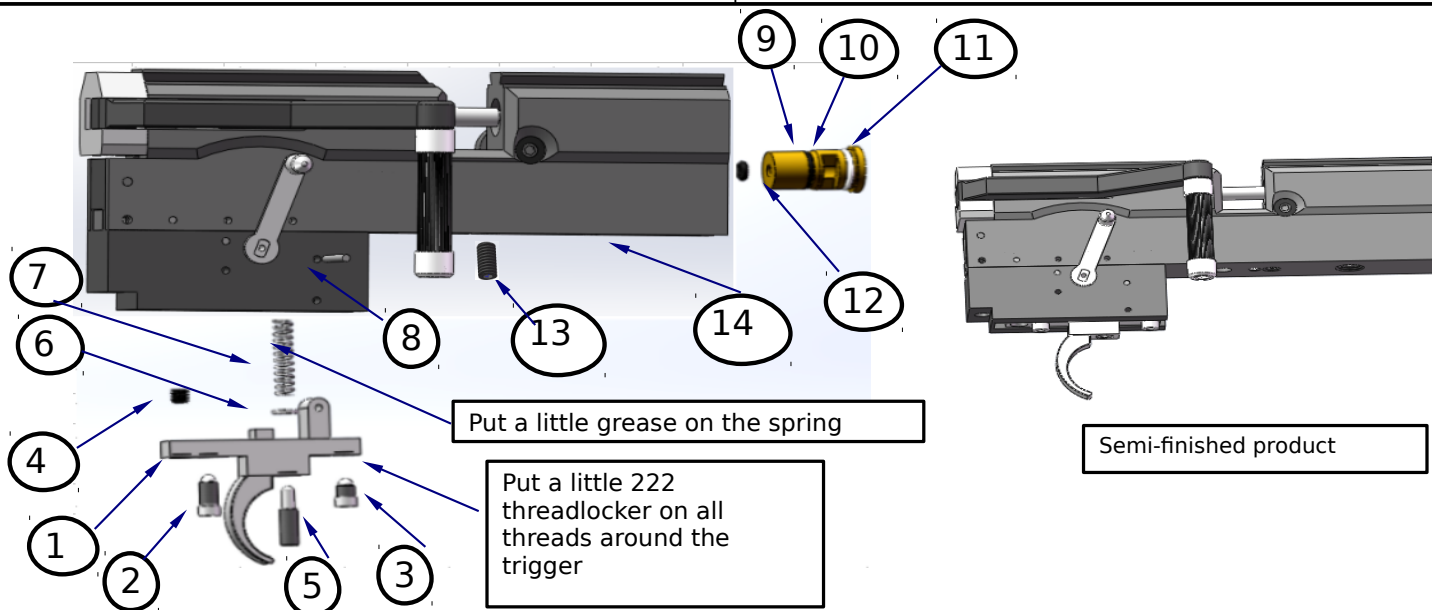

No	Material Name	Material Code	Quantity	Remark
1	Trigger	000P2-074-W-00	1	
2	Trigger bracket adjustment screw 2	000P2-088-W-00	1	
3	Trigger bracket adjustment screw 1	000P2-092-W-00	1	
4	Flat point allen screw M5×4 (grade 10.9)	/	1	
5	Trigger pull adjustment screw	000P2-144-W-00	1	
6	Trigger pull adjustment flat washer	000P2-143-W-00	1	
7	Trigger spring	000P2-158-W-00	1	
8	Aluminum valve body horizontal pin 1	000P2-091-W-00	1	
9	Air release valve sleeve	000P2-125-W-00	1	
10	NBR o-ring $\phi 1.5 \times 11$ hardness 90°	000P2-008-X-00	1	
11	PU o-ring $\phi 1.5 \times 12$ hardness 90°	000P2-048-X-00	1	
12	NBR o-ring $\phi 1.5 \times 6$ hardness 90°	000P2-034-X-00	1	
13	Cone point allen screw M4×8	000P2-059-W-00	1	
14				
15				

(I) Pressure relief valve front part assembly

Process Code: P1WI

Date: July 2018

Video Code: V-P1WI

Version: 1.0

Product Code: HP-P1000W/HP-P900W

Product Name: P1W (Wood) .177/.22

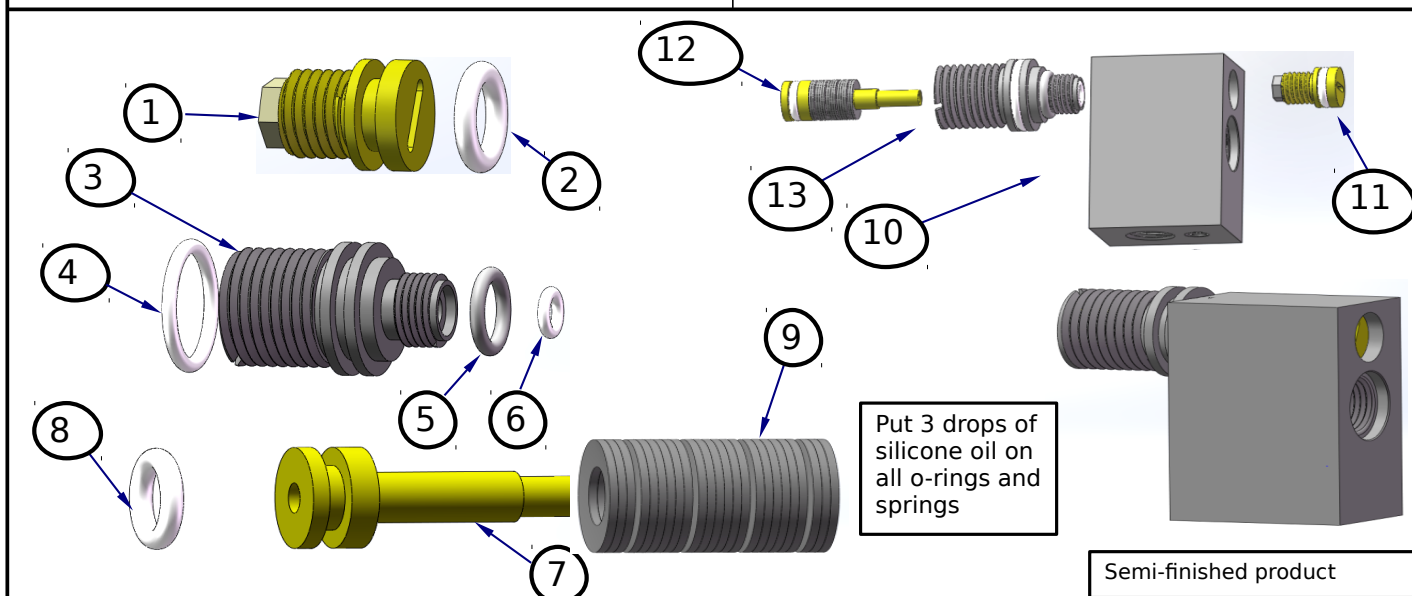

No	Material Name	Material Code	Quantity	Remark
1	Pressure relief valve screw assembly	000P1-021-Z-00	1	
2	PU o-ring $\phi 2 \times \phi 10$ hardness 90°_x000D_	000P1-002-X-00	1	
3	Pressure relief valve connecting sleeve	000P1-011-W-00	1	
4	PU o-ring $\phi 2 \times \phi 18$ hardness 90°_x000D_	000P1-004-X-00	1	
5	NBR o-ring $\phi 2 \times 12$ hardness 90°	000P2-007-X-00	1	
6	PU o-ring $\phi 1.65 \times 7$ hardness 90°_x000D_	000P1-024-X-00	1	
7	Pressure relief valve stem	000P1-010-W-00	1	
8	PU o-ring $\phi 2 \times \phi 10$ hardness 90°_x000D_	000P1-002-X-00	1	
9	Pressure relief valve butterfly spring	000P2-103-W-00	24	
10	Pressure relief valve body	000P1-009-W-00	1	
11	Pressure relief valve screw assembly semi-finished product	000P2-144-W-00	1	
12	Pressure relief valve stem semi-finished product	000P2-066-W-00	1	
13	Pressure relief valve connecting sleeve semi-finished product	000P2-078-W-00	1	
14				
15				

(J) Pressure relief valve rear part assembly

Process Code: P1WJ

Date: July 2018

Video Code: V-P1WJ

Version: 1.0

Product Code: HP-P1000W/HP-P900W

Product Name: P1W (Wood) .177/.22

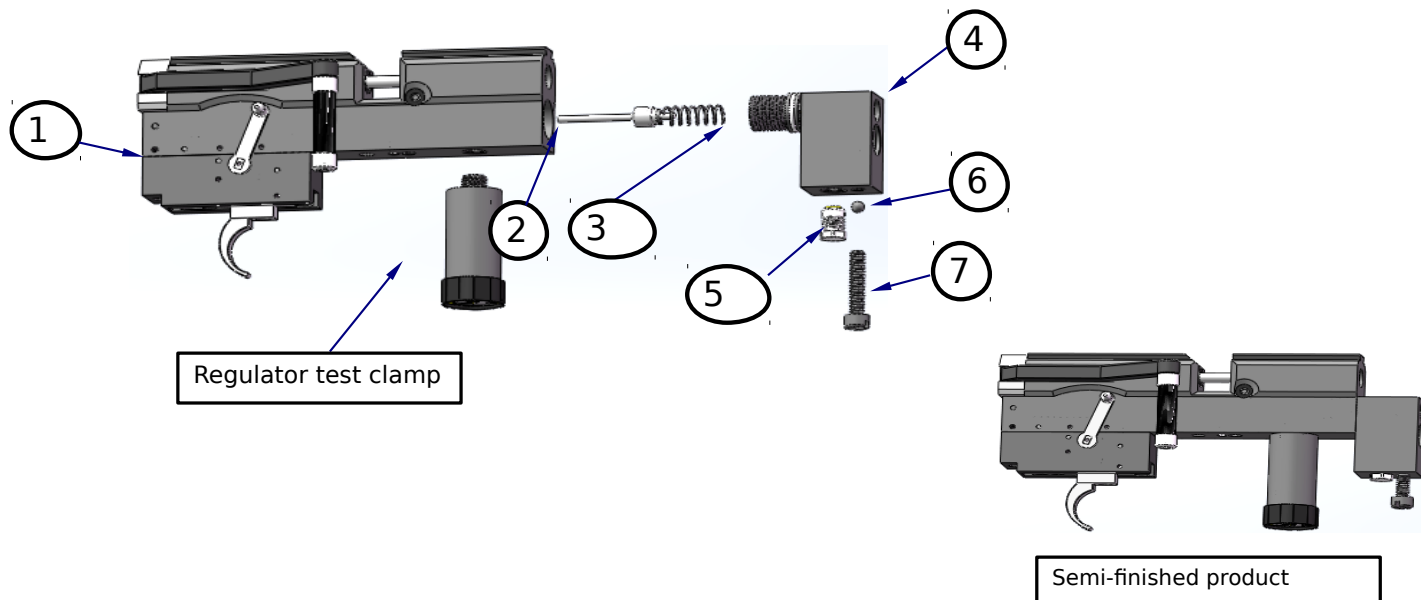

No	Material Name	Material Code	Quantity	Remark
1	Aluminum valve body semi-finished product	/	1	
2	Air release valve stem	/	1	
3	Air release valve spring	000P2-101-W-00	1	
4	Pressure relief valve body semi-finished product	/	1	
5	Safety valve 6K	000P1-022-Z-00	1	
6	Bearing steel ball $\phi 4$	000P2-063-W-00	1	
7	Pan head slotted screw M6×30 (wood stock)	000P1-041-W-00	1	
8				
9				
10				
11				
12				
13				
14				
15				

(K) Inner barrel assembly

Process Code: P1WK

Date: July 2018

Video Code: V-P1WK

Version: 1.0

Product Code: HP-P1000W/HP-P900W

Product Name: P1W (Wood) .177/.22

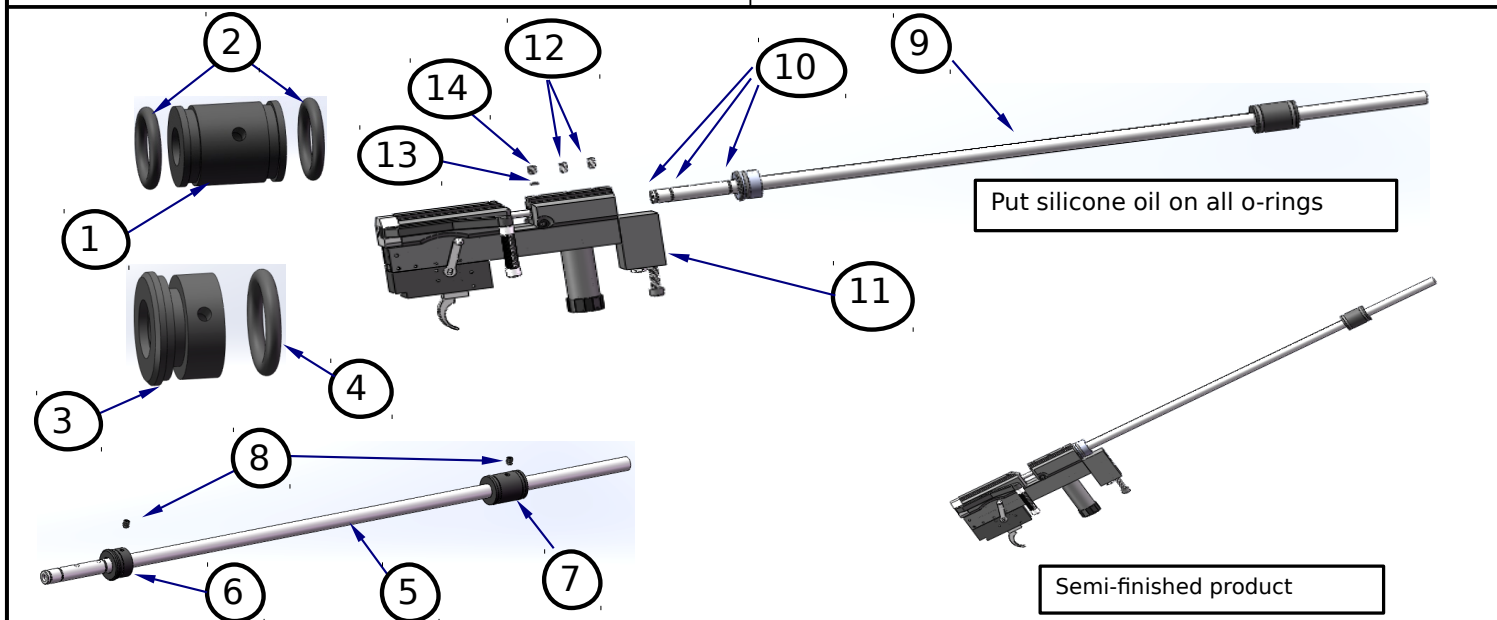

No	Material Name	Material Code	Quantity	Remark
1	Shroud barrel front support sleeve	000P2-003-S-01	1	
2	NBR o-ring $\phi 3 \times 23$ hardness 70°	000P2-028-X-00	1	
3	Shroud barrel rear support sleeve	000P2-004-S-00	1	
4	NBR o-ring $\phi 3 \times 23$ hardness 70°	000P2-028-X-00	1	
5	Inner barrel (P1/P2)	000P2-040-W-00 (.177) / 000P1-031-W-00 (.22)	1	
6	Shroud barrel rear support sleeve semi-finished product	/	1	
7	Shroud barrel front support sleeve semi-finished product	/	1	
8	Cone point allen screw M4×6×120°(cone)	000P2-036-W-00	2	
9	Inner barrel semi-finished product	/	1	
10	NBR o-ring $\phi 1.5 \times 11$ hardness 90°	000P2-029-X-00	3	
11	Gun body semi-finished product	/	1	
12	Cone point allen screw M5×8×120°(cone)	000P2-038-W-00	1	
13	NBR o-ring $\phi 1.5 \times 5.5$ hardness 90°	000P2-030-X-00	1	
14	Cone point allen screw M6×6×120°(cone)	000P2-039-W-00	1	
15				

(L) Shroud barrel and regulator chamber assembly

Process Code: P1WL

Date: July 2018

Video Code: V-P1WL

Version: 1.0

Product Code: HP-P1000W/HP-P900W

Product Name: P1W (Wood) .177/.22

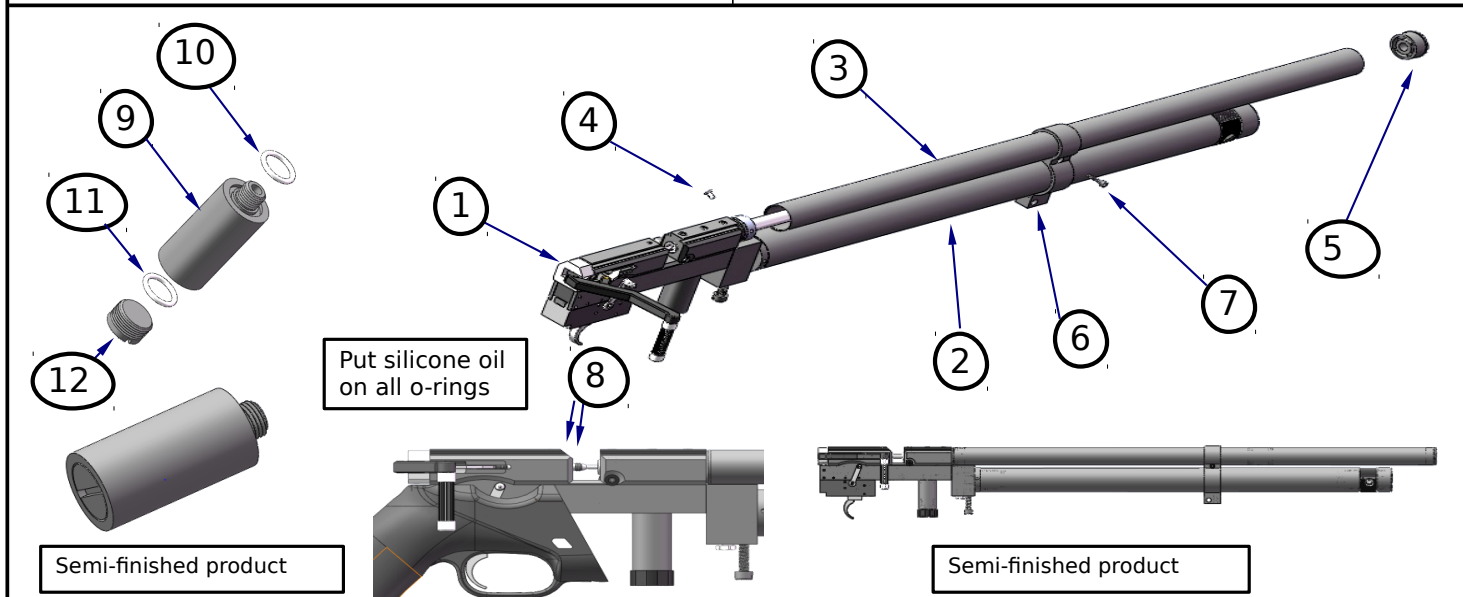

No	Material Name	Material Code	Quantity	Remark
1	Gun body semi-finished product	/	1	
2	Air reservoir Semi-finished product	/	1	
3	Shroud barrel	000P2-035-W-00	1	
4	Flat head allen screw M3×5_x000D_	000P2-032-W-00	1	
5	Shroud barrel front plug	000P2-002-S-00	1	
6	Air reservoir front plug ring	000P1-017-W-00	1	
7	Round head allen screw M3×16_x000D_	000P1-057-W-00	1	
8	Pellet probe o-ring	0PCP1-001-X-00 (.177) / 0PCP1-004-X-00 (.22)	2	
9	Regulator chamber	000P1-033-W-00	1	
10	PU o-ring $\phi 16 \times \phi 2$ hardness 90°	000P1-023-X-00	1	
11	PU o-ring $\phi 16 \times \phi 2$ hardness 90°	000P1-023-X-00	1	
12	Regulator chamber plug	000P1-034-W-00	1	
13				
14				
15				

(M) Leakage and regulator test

Process Code: P1WM

Date: July 2018

Video Code: V-P1WM

Version: 1.0

Product Code: HP-P1000W/HP-P900W

Product Name: P1W (Wood) .177/.22

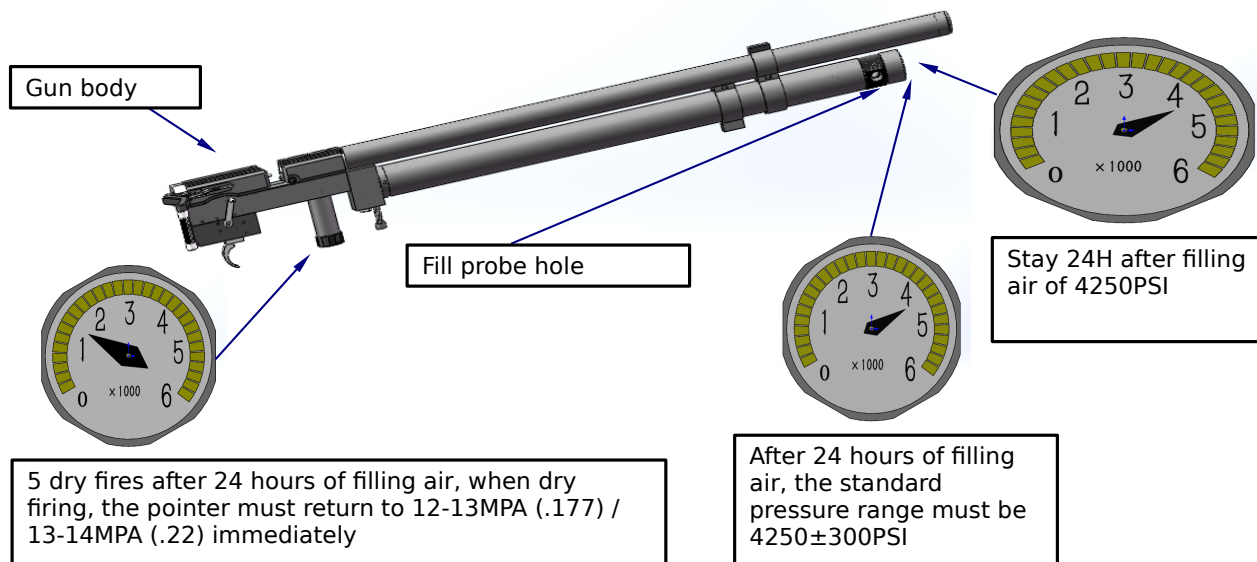

No	Material Name	Material Code	Quantity	Remark
1				
2				
3				
4				
5				
6				
7				
8				
9				
10				
11				
12				
13				
14				
15				

(N) Stock assembly

Process Code: P1WN

Date: July 2018

Video Code: V-P1WN

Version: 1.0

Product Code: HP-P1000W/HP-P900W

Product Name: P1W (Wood) .177/.22

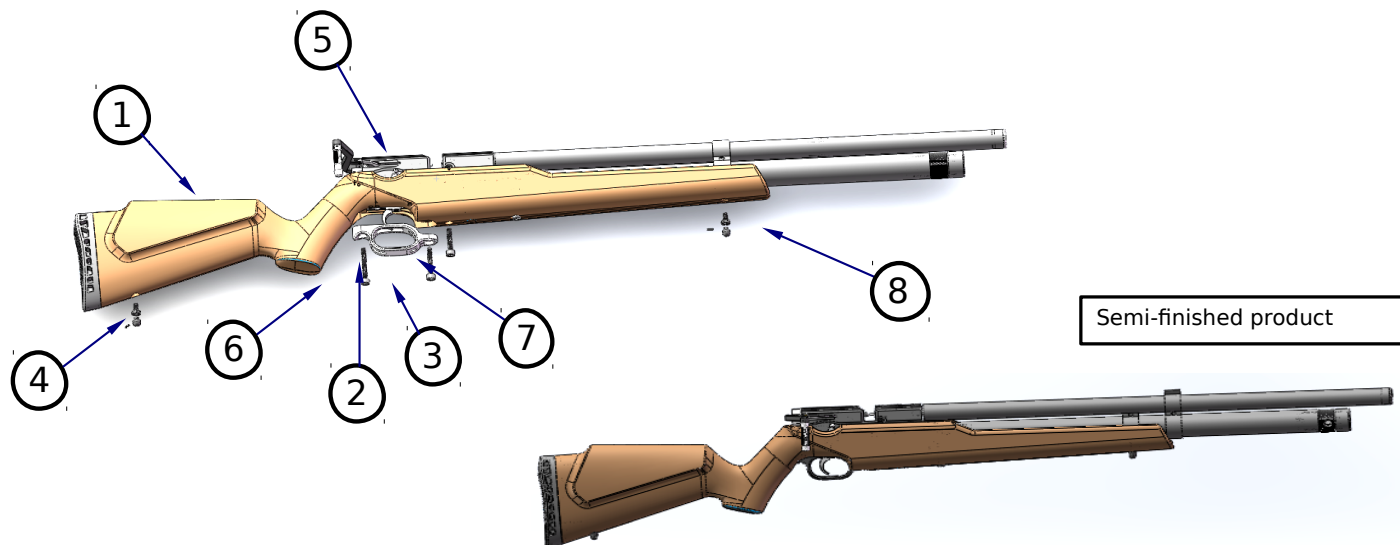

No	Material Name	Material Code	Quantity	Remark
1	Wood stock P1	000P1-007-B-00	1	
2	Trigger guard	000P1-035-W-00	1	
3	Round head allen screw M5×40	000P1-040-W-00	1	
4	Front sling swivel	/	1	
5	Gun body semi-finished product	/	1	
6	Round head allen screw M5×32	000P2-115-W-00	1	
7	Round head allen screw M5×45	000P1-039-W-00	1	
8	Front sling swivel	/	1	
9				
10				
11				
12				
13				
14				
15				

(O) Spare parts and packaging

Process Code: P1WO

Date: July 2018

Video Code: V-P1WO

Version: 1.0

Product Code: HP-P1000W/HP-P900W

Product Name: P1W (Wood) .177/.22

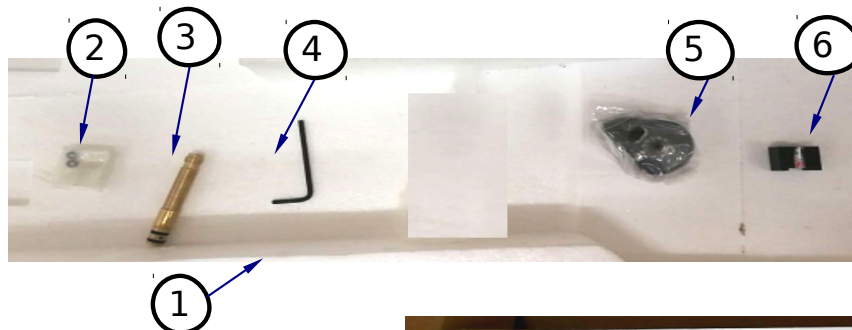

The position of magazine



The position of fill probe and allen wrench

The position of o-ring

The position of single shot tray

No	Material Name	Material Code	Quantity	Remark
1	Polyfoam bottom cover P2	000P1-004-B-00	1	
2	Pellet probe o-ring	OPCP1-001-X-00 (.177) / OPCP1-004-X-00 (.22)	2	
3	Fill probe P2	/	1	
4	Allen wrench 2.5mm	000P2-128-W-00	1	
5	Magazine	HPA1000-007-Z-00 (.177) / HPA1000-010-Z-00 (.22)	1	
6	Single shot tray	/	1	
7				
8				
9				
10				
11				
12				
13				
14				
15				